



# ACCURATE & EASY TO USE

Discover a wide selections of our  
sound measurement equipments according to your  
sound measurement needs

## PLACID CALIBRATION CA-01 USER MANUAL

[www.placidinstruments.com](http://www.placidinstruments.com)

PLC/CA-01/M/24/V1



**PLACID INSTRUMENTS BV**

Newtonlaan 115 Office No. 2.21 3584 BH UTRECHT, THE NETHERLANDS

Phone +31 302106021

email [info@placidinstruments.com](mailto:info@placidinstruments.com)

website [www.placidinstruments.com](http://www.placidinstruments.com)

**PLACID CA-01 MANUAL**



PLACID SOUND  
CALIBRATOR

**CA-01**



PLACID INSTRUMENTS BV

Newtonlaan 115 Office No. 2.21 3584 BH UTRECHT, THE NETHERLANDS

Phone Landline: +31 302106021

Worldwide (except Europe): +31 613915102

Europe: +31 622813335

info@placidinstruments.com

www.placidinstruments.com

PLACID CA-01 MANUAL

1 CONTENT

<b>-Safety Information</b>	1
Environment Conditions	1
Maintenance & Clearing	1
Safety symbols	1
<b>-Description</b>	2
<b>-Features.</b>	2
<b>-Specifications</b>	2
Output sound pressure levels	2
Output frequency	2
Reference conditions	2
Influence of ambient conditions	2
Total Harmonic Distortion(THD)	2
Accuracy of sound pressure level	2
Power	2
Battery life	2
Battery test	2
Dimensions	2
Weight	2
Ambient conditions	2
Storage temperature & humidity	2
Accessories	2
<b>-Nomenclature And Function</b>	3
<b>-Operating Preparation</b>	4
<b>-Calibration Procedure</b>	5



**PLACID INSTRUMENTS BV**

Newtonlaan 115 Office No. 2.21 3584 BH UTRECHT, THE NETHERLANDS

Phone Landline: +31 302106021

Worldwide (except Europe): +31 613915102

Europe: +31 622813335

[info@placidinstruments.com](mailto:info@placidinstruments.com)

[www.placidinstruments.com](http://www.placidinstruments.com)

PLACID CA-01 MANUAL

1

## 1 Safety Procedure

### 1. Safety Information

Read the following safety information carefully before attempting to operate or service the meter.

Use the meter only as specified in this manual; otherwise, the protection provided by the meter may be impaired.

Environment Conditions

- Altitude up to 2000 meters
- Relative humidity 90% max.
- Operation Ambient 0 to 40°C

Maintenance & Clearing

Repairs or servicing not covered in this manual should only be performed by qualified personnel.

Periodically wipe the case with a dry cloth. Do not use abrasives or solvents on this instrument.

**CE** Comply with EMC

When servicing, use only specified replacement parts.

## 2 General Description

Sound level calibrator is used to calibrate sound level meters and other sound measurement equipment. You can calibrate 1 inch diameter microphones directly and 1/2 inch microphones using 1/2 inch adaptor supplied with the calibrator. With available adaptors, you can calibrate other microphones and instruments.



**PLACID INSTRUMENTS BV**

Newtonlaan 115 Office No. 2.21 3584 BH UTRECHT, THE NETHERLANDS

Phone Landline: +31 302106021

Worldwide (except Europe): +31 613915102

Europe: +31 622813335

[info@placidinstruments.com](mailto:info@placidinstruments.com)

[www.placidinstruments.com](http://www.placidinstruments.com)

PLACID CA-01 MANUAL

2

3 Features

Conforms to ANSI

Calibration levels of 94dB and 114dB.

Fit 1 inch and 1/2 inch diameter microphone.

4 Specification

- **Sound calibrator** class 1 according to EN/IEC 60942:2017 Class 1
- **Microphone size:** 1/1" and 1/2"
- **Sound Pressure Level @ Reference conditions:** 94 ±0.25 dB / 114 ±0.25 dB
- **Frequency:** 1000 ±0.7% Hz
- **Total Harmonic Distortion + Noise:** <2%
- **Reference Conditions:**
  - Temperature** 23°C(73°F)
  - Static press** 103hpa
  - Relative humidity** 50%
- **Power:** one 9V battery 006P or IEC 6F22 or NEDA 1604.
- **Battery life:** approx.40 hours.(Alkaline Battery )
- **Battery test:** Internal circuitry checks condition of battery continuously. Calibrator will not be operated when green LED turns to red LED, which means that battery voltage falls below acceptable range.
- **Dimensions:** 113(L)x63(W)x44(H)mm,4.4(L)x2.4(W)x1.7(H)inch
- **Ambient condition:** 650 – 1080 hpa, -10 °C to +50 °C , 10 – 90% RH
- **Weight:** approx. 170 gram (including battery)



**PLACID INSTRUMENTS BV**

Newtonlaan 115 Office No. 2.21 3584 BH UTRECHT, THE NETHERLANDS

Phone Landline: +31 302106021

Worldwide (except Europe): +31 613915102

Europe: +31 622813335

info@placidinstruments.com

www.placidinstruments.com

PLACID CA-01 MANUAL

3

## 5 Nomenclature And Functions

1. Power and low battery indicate LED.
2. Power and output level select switch.
3. Transducer assembly 1-inch cavity for microphone insertion.
4. 1/2-inch microphone adapter.
5. Battery cover.

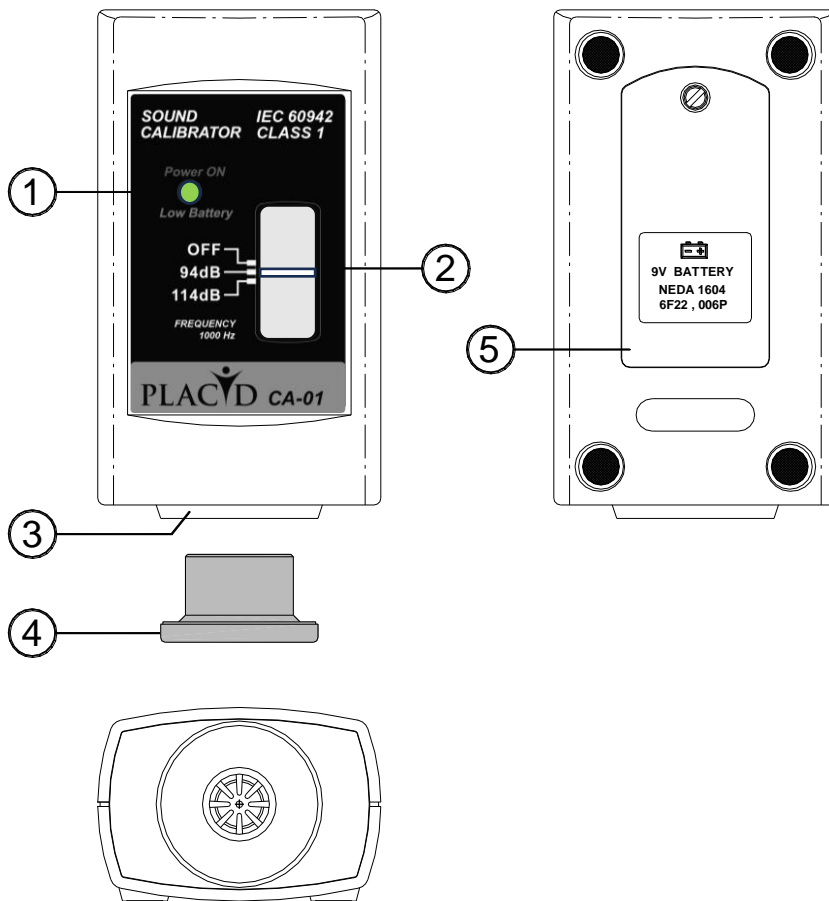



**PLACID INSTRUMENTS BV**

Newtonlaan 115 Office No. 2.21 3584 BH UTRECHT, THE NETHERLANDS

Phone Landline: +31 302106021

Worldwide (except Europe): +31 613915102

Europe: +31 622813335

[info@placidinstruments.com](mailto:info@placidinstruments.com)

[www.placidinstruments.com](http://www.placidinstruments.com)

PLACID CA-01 MANUAL

## 6 Operating Preparation

1. Remove battery cover and install a 9V Battery in the battery compartment.
2. To quickly check the operation of the sound level calibrator.

**Before using it, proceed as follows:**

- a) Turn the power switch from OFF to the 94dB position. The user can start to operate it when LED indicates the green light. If no, please replace the battery.
- b) Change the switch from 94dB to 114dB, the 20dB increase in level. You can calibrate in noisy environments and check linearity.



**PLACID INSTRUMENTS BV**

Newtonlaan 115 Office No. 2.21 3584 BH UTRECHT, THE NETHERLANDS

Phone Landline: +31 302106021

Worldwide (except Europe): +31 613915102

Europe: +31 622813335

info@placidinstruments.com

www.placidinstruments.com

PLACID CA-01 MANUAL

7 Calibration Procedure



1. The cavity of the calibrator will accommodate 1-inch microphone.
2. When the calibration is performed to a instrument with 1/2-inch microphone, the 1/2-inch microphone adaptor will have to be inserted by gently pushing it into the cavity till the end.
3. Place the sound level calibrator over the microphone of the sound measuring instrument being calibrated.
4. On the instrument under test, set the level range control to the range having 100dB as its upper limit if 94dB was selected on the sound level calibrator. If 114dB was selected on the sound level calibrator, choose a range with on upper limit of 120dB. The instrument may be set to FAST or SLOW response and C or A weighting.
5. Read the level on the instrument under test and adjust the sensitivity control for the correct indication of the sound level calibrator level selected in step.
6. When the calibrator is not worked, please switch OFF the power to save the battery.





**PLACID INSTRUMENTS BV**

Newtonlaan 115 Office No. 2.21 3584 BH UTRECHT, THE NETHERLANDS

Phone Landline: +31 302106021

Worldwide (except Europe): +31 613915102

Europe: +31 622813335

[info@placidinstruments.com](mailto:info@placidinstruments.com)

[www.placidinstruments.com](http://www.placidinstruments.com)

PLACID CA-01 MANUAL

6

8 Operating Precaution

Ambient sources of noise or vibration can cause a false calibration indication, this can be especially signification at the **lower 84dB level**.



Placid Instruments BV

Newtonlaan 115, Office No. 2.21

3584 BH UTRECHT

THE NETHERLANDS

Phone landline : +31 302106021

Email : [info@placidinstruments.com](mailto:info@placidinstruments.com)

[www.placidinstruments.com](http://www.placidinstruments.com)

ASK US!  
HERE

